



DISCOUNTS

	List Price
1 - 5	
6-19	-12%
20-39	-25%
40-59	-33%
60-99	-37%
100-199	-42%
200-399	-48%
400-499	-51%
500+	-55%

PART NUMBER	Shaft Dia. (d)		Dimensions (mm)						
	(in.)	(mm)	N1	L2	H2	N2	N	L3	A1
HPCUCT204-12	3/4	-	16	10	51	32	19	51	12
HPCUCT204	-	20	16	10	51	32	19	51	12
HPCUCT205-14	7/8	-	16	10	51	32	19	51	12
HPCUCT205	-	25	16	10	51	32	19	51	12
HPCUCT205-16	1	-	16	10	51	32	19	51	12
HPCUCT206-18	1 1/8	-	16	10	56	37	22	57	12
HPCUCT206	-	30	16	10	56	37	22	57	12
HPCUCT206-20	1 1/4	-	16	10	56	37	22	57	12
HPCUCT207-22	1 3/8	-	16	13	64	37	22	64	12
HPCUCT207	-	35	16	13	64	37	22	64	12
HPCUCT208-24	1 1/2	-	19	16	83	49	29	83	16
HPCUCT208	-	40	19	16	83	49	29	83	16
HPCUCT209-28	1 3/4	-	19	16	83	49	29	83	16
HPCUCT209	-	45	19	16	83	49	29	83	16
HPCUCT210-30	1 7/8	-	19	16	83	49	29	86	16
HPCUCT210	-	50	19	16	83	49	29	86	16
HPCUCT211-32	2	-	25	19	102	64	35	95	22
HPCUCT211-34	2 1/8	-	25	19	102	64	35	95	22
HPCUCT211	-	55	25	19	102	64	35	95	22

Material
Cast Iron Housing

Shafts & Bearings

Take-Up Units

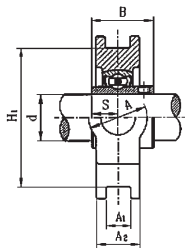
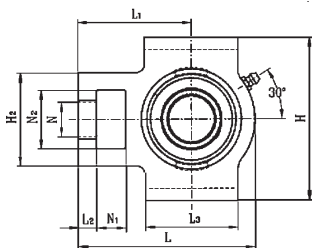

PART NUMBER	Dimensions (mm)								Weight (kg)	PRICE EACH 1-5
	H1	H	L	A	A2	L1	B	S		
HPCUCT204-12	76	89	94	32	21	61	31	12.7	0.790	£22.02
HPCUCT204	76	89	94	32	21	61	31	12.7	0.790	£22.02
HPCUCT205-14	76	89	97	32	24	62	34	14.3	0.880	£24.22
HPCUCT205	76	89	97	32	24	62	34	14.3	0.880	£25.78
HPCUCT205-16	76	89	97	32	24	62	34	14.3	0.880	£26.55
HPCUCT206-18	89	102	113	37	28	70	38.1	15.9	1.300	£28.74
HPCUCT206	89	102	113	37	28	70	38.1	15.9	1.300	£31.32
HPCUCT206-20	89	102	113	37	28	70	38.1	15.9	1.300	£28.74
HPCUCT207-22	89	102	129	37	30	78	42.9	17.5	1.700	£36.15
HPCUCT207	89	102	129	37	30	78	42.9	17.5	1.700	£36.78
HPCUCT208-24	102	114	144	49	33	88	49.2	19	2.500	£42.24
HPCUCT208	102	114	144	49	33	88	49.2	19	2.500	£39.88
HPCUCT209-28	102	117	144	49	35	87	49.2	19	2.500	£47.46
HPCUCT209	102	117	144	49	35	87	49.2	19	2.500	£46.73
HPCUCT210-30	102	117	149	49	37	90	51.6	19	2.600	£47.85
HPCUCT210	102	117	149	49	37	90	51.6	19	2.600	£52.96
HPCUCT211-32	130	146	171	64	38	106	55.6	22.2	4.000	£66.25
HPCUCT211-34	130	146	171	64	38	106	55.6	22.2	4.000	£60.44
HPCUCT211	130	146	171	64	38	106	55.6	22.2	4.000	£69.07

Shafts & Bearings Take-Up Units



Shafts & Bearings

Material

Take-Up Units

Cast Iron Housing



DISCOUNTS

	List Price
1 - 5	
6-19	-12%
20-39	-25%
40-59	-33%
60-99	-37%
100-199	-42%
200-399	-48%
400-499	-51%
500+	-55%

Shafts & Bearings Take-Up Units

PART NUMBER	Shaft Dia. (d)		Dimensions (mm)						
	(in.)	(mm)	N1	L2	H2	N2	N	L3	A1
HPCUCT212-36	2 1/4	-	32	19	102	64	35	102	22
HPCUCT212	-	60	32	19	102	64	35	102	22
HPCUCT212-38	2 3/8	-	32	19	102	64	35	102	22
HPCUCT213-40	2 1/2	-	32	21	111	70	41	121	26
HPCUCT213	-	65	32	21	111	70	41	121	26
HPCUCT214-44	2 3/4	-	32	21	111	70	41	121	26
HPCUCT214	-	70	32	21	111	70	41	121	26
HPCUCT215	-	75	32	21	111	70	41	121	26
HPCUCT215-48	3	-	32	21	111	70	41	121	26
HPCUCT216	-	80	32	21	111	70	41	121	26
HPCUCT217-52	3 1/4	-	38	29	124	73	48	157	30
HPCUCT217	-	85	38	29	124	73	48	157	30

'Never Knowingly Outpriced'

4.58



Unit 14, Foxwood Industrial Park, Foxwood Rd. Chesterfield, Derbyshire S41 9RN

Telephone +44(0)1246 268080 Fax +44(0)1246 260003

Material
Cast Iron Housing

Shafts & Bearings

Take-Up Units

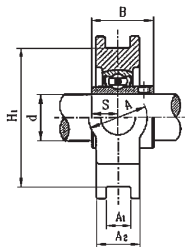
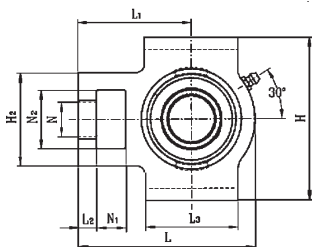

PART NUMBER	Dimensions (mm)								Weight (kg)	PRICE EACH 1-5
	H1	H	L	A	A2	L1	B	S		
HPCUCT212-36	130	146	194	64	42	119	65.1	25.4	4.900	£89.08
HPCUCT212	130	146	194	64	42	119	65.1	25.4	4.900	£83.17
HPCUCT212-38	130	146	194	64	42	119	65.1	25.4	4.900	£81.25
HPCUCT213-40	151	167	224	70	44	137	65.1	25.4	7.000	£144.42
HPCUCT213	151	167	224	70	44	137	65.1	25.4	7.000	£98.31
HPCUCT214-44	151	167	224	70	46	137	74.6	30.2	7.100	£131.75
HPCUCT214	151	167	224	70	46	137	74.6	30.2	7.100	£135.78
HPCUCT215	151	167	232	70	48	140	77.8	33.3	7.500	£169.09
HPCUCT215-48	151	167	232	70	48	140	77.8	33.3	7.500	£165.57
HPCUCT216	165	184	235	70	51	140	82.6	33.3	8.200	£193.83
HPCUCT217-52	173	198	260	73	54	162	85.7	34.1	11.000	£236.46
HPCUCT217	173	198	260	73	54	162	85.7	34.1	11.000	£228.91

Shafts & Bearings Take-Up Units



Shafts & Bearings

Material

Take-Up Units

Cast Iron Housing



DISCOUNTS

Quantity	List Price
1 - 5	-12%
6-19	-25%
20-39	-33%
40-59	-37%
60-99	-42%
100-199	-48%
200-399	-51%
400-499	-55%
500+	-55%

Shafts & Bearings Take-Up Units

PART NUMBER	Shaft Dia. (d)		Dimensions (mm)						
	(in.)	(mm)	N1	L2	H2	N2	N	L3	A1
HPCUCST204-12	3/4	-	16	10	51	32	19	51	13.5
HPCUCST204	-	20	16	10	51	32	19	51	13.5
HPCUCST205-14	7/8	-	16	10	51	32	19	51	13.5
HPCUCST205	-	25	16	10	51	32	19	51	13.5
HPCUCST205-16	1	-	16	10	51	32	19	51	13.5
HPCUCST206-18	1 1/8	-	16	10	56	37	22	57	13.5
HPCUCST206	-	30	16	10	56	37	22	57	13.5
HPCUCST207-20	1 1/4	-	16	13	64	37	22	64	13.5
HPCUCST207-22	1 3/8	-	16	13	64	37	22	64	13.5
HPCUCST207	-	35	16	13	64	37	22	64	13.5
HPCUCST208-24	1 1/2	-	19	16	83	49	29	83	17.5
HPCUCST208	-	40	19	16	83	49	29	83	17.5
HPCUCST209-26	1 5/8	-	19	16	83	49	29	83	17.5
HPCUCST209-28	1 3/4	-	19	16	83	49	29	83	17.5
HPCUCST209	-	45	19	16	83	49	29	83	17.5
HPCUCST210-30	1 7/8	-	19	16	83	49	29	86	17.5
HPCUCST210	-	50	19	16	83	49	29	86	17.5
HPCUCST211-32	2	-	25	19	102	64	35	95	27
HPCUCST211-34	2 1/8	-	25	19	102	64	35	95	27
HPCUCST211	-	55	25	19	102	64	35	95	27
HPCUCST212-36	2 1/4	-	32	19	102	64	35	102	27
HPCUCST212	-	60	32	19	102	64	35	102	27
HPCUCST212-38	2 3/8	-	32	19	102	64	35	102	27

4.60



Unit 14, Foxwood Industrial Park, Foxwood Rd, Chesterfield, Derbyshire S41 9RN

Telephone +44(0)1246 268080 Fax +44(0)1246 260003

Material
Cast Iron Housing

Shafts & Bearings

Take-Up Units

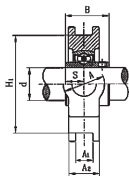
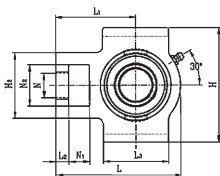

PART NUMBER	Dimensions (mm)									Weight (kg)	PRICE EACH 1-5
	H1	H	L	A	A2	L1	B	S			
HPCUCST204-12	76	89	94	32	21	61	31	12.7	0.800	£15.45	
HPCUCST204	76	89	94	32	21	61	31	12.7	0.800	£15.10	
HPCUCST205-14	76	89	97	32	24	62	34	14.3	0.880	£18.37	
HPCUCST205	76	89	97	32	24	62	34	14.3	0.880	£17.92	
HPCUCST205-16	76	89	97	32	24	62	34	14.3	0.880	£18.37	
HPCUCST206-18	89	102	113	37	28	70	38.1	15.9	1.300	£21.78	
HPCUCST206	89	102	113	37	28	70	38.1	15.9	1.300	£21.29	
HPCUCST207-20	89	102	129	37	30	78	42.9	17.5	1.700	£25.05	
HPCUCST207-22	89	102	129	37	30	78	42.9	17.5	1.700	£25.05	
HPCUCST207	89	102	129	37	30	78	42.9	17.5	1.700	£24.42	
HPCUCST208-24	102	114	144	49	33	88	49.2	19	2.500	£29.26	
HPCUCST208	102	114	144	49	33	88	49.2	19	2.500	£28.57	
HPCUCST209-26	102	117	144	49	35	87	49.2	19	2.500	£32.99	
HPCUCST209-28	102	117	144	49	35	87	49.2	19	2.500	£32.99	
HPCUCST209	102	117	144	49	35	87	49.2	19	2.500	£32.22	
HPCUCST210-30	102	117	149	49	37	90	51.6	19	2.600	£36.33	
HPCUCST210	102	117	149	49	37	90	51.6	19	2.600	£35.46	
HPCUCST211-32	130	146	171	64	38	106	55.6	22.2	4.000	£49.20	
HPCUCST211-34	130	146	171	64	38	106	55.6	22.2	4.000	£49.20	
HPCUCST211	130	146	171	64	38	106	55.6	22.2	4.000	£48.05	
HPCUCST212-36	130	146	194	64	42	119	65.1	25.4	4.900	£61.70	
HPCUCST212	130	146	194	64	42	119	65.1	25.4	4.900	£60.20	
HPCUCST212-38	130	146	194	64	42	119	65.1	25.4	4.900	£61.70	

Shafts & Bearings Take-Up Units

